

DFG-153 (Dual Flange Gaskets)

Material Composition and Application

High Performance. 175" Thick – Penta Layered Graphite with 99.85% carbon content and 316SS Dual Flange Gaskets (Class 150/300). Multi-layer graphite with 316SS inserts provides high compressive strength, blow-out resistance, excellent handling properties and improved tightness. The unique geometry of this gasket offers multiple benefits for the user.

Benefits

Excellent Resistance

- Pure exfoliated graphite flake material excels in extreme conditions, withstanding heat & pressure
- Fire-safe
- Chemical resistant
- No ageing, unlimited shelf life

Reliable Seal

- Seals easily under moderate bolt load, offers superior torque retention
- Retains dimensional stability in high temperature; seals tightly even during pressure fluctuations
- Perfect for pitted and scratched flanges

Safety

- Elastomer free means no premature failures at elevated temperatures
- Ideal for hydrostatic testing
- No sharp edges

Inventory Management

- One gasket for both 150# and 300# flanges
- Only 18 SKU's to manage from 1/2" to 24"
(Reduced from 36)

Min. Temperature	-400°F
Max. Temperature	+850°F (+454°C) (in atmosphere) +1200°F (+650°C) (in steam)
Max. Pressure	2000 psig (137 bar)
pH	0-14
PXT (Max)	175,000 (6,000)
M Factor	2 (Smooth Flange Surface)
Y Stress	900 psi (6 MPa) (Smooth Flange Surface)
Max. Gasket Load	24,000 psi (165 MPa)

Available with dove-tailed tabs for gasket alignment and visual indicator.

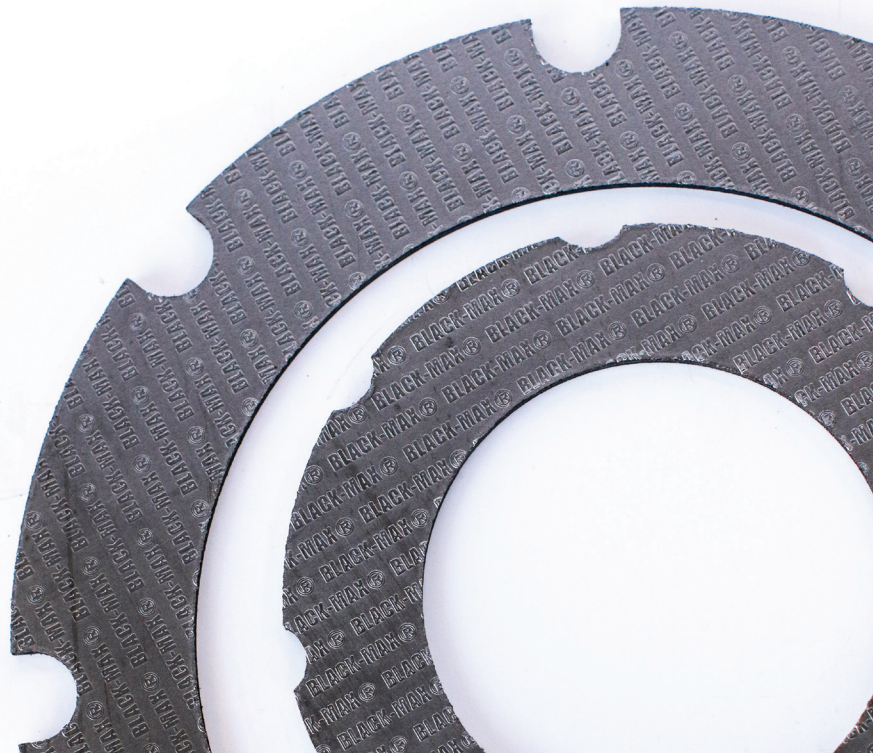
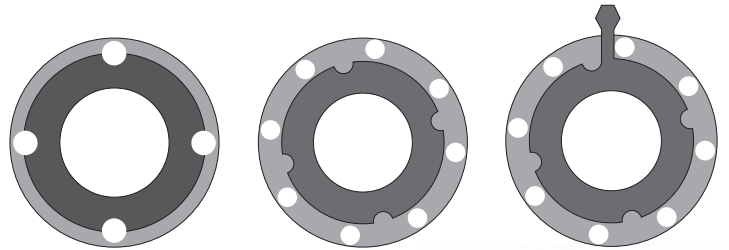

STEAMWORKS